

NON-RETURN VALVE NV400

intermediate flange version



WITT non-return valves for reliable protection against dangerous reverse gas flow. Now available also with welding neck flanges for simple installing and removing. Every non-return valve 100% tested.

Benefits

- a spring loaded non-return valve prevents back feeding of gases which could lead to unwanted gas mixtures
- low pressure drops – using complex valve assembly with low opening pressure – approx. 3.0 mbar
- no leaks – using of a spring loaded valve assembly with elastomer sealing
- stainless steel filter (100 µm) in the gas inlet protects the non-return valve against dirt contamination, extending the service life
- dirt filter in gas inlet are replaced quickly and easily
- diverse applications – useful for many technical gases
- reduce installation costs – the spring loaded valve is not affected by gravity and may be installed in any orientation
- non-return valve as „intermediate flange version“ guarantees quick and uncomplicated removal and installation at replacement and annual testing
- maximum flexibility – screwed non-return valve as well as installed between flanges. Complete (non-return valve + flange-set) or as add-on kit available.
- spacer tubes around threaded rods (M16) for secure centering of non-return
- flange connection with weld-on connecting according to EN 1092-1 Type11
- equal length in brass and stainless steel non-return valves for optimal interchangeability and combination with flange-kits (as well as DN40 and DN50)

Operation / Usage

- non-return valves are used to protect equipment and pipelines against dangerous reverse gas flow.
- use is possible for applications according to EN 746-2
- non-return valves are tested to DIN EN ISO 5175-2. They may also used as a safety device to protect against flash-backs (proved in accordance to DIN EN ISO 5175-1 point 6.7) from combustion natural gas with air
- WITT non-return valves may be mounted in any position / orientation
- the maximum ambient / working temperature is 70 °C / 158 °F

Maintenance

- annual testing of the non-return valve, body leak tightness and flow capacity is recommended
- WITT is happy to supply special test equipment
- non-return valves are only to be serviced by the manufacturer. The dirt filter may be replaced according to model by competent staff

Approvals

Company certified according to ISO 9001 and PED 2014/68/EU Module H
CE-marked according to
- PED 2014/68/EU
Cleaned for Oxygen Service according to:
- EIGA IGC Doc 13/12/E: Oxygen Pipeline and Piping Systems

NON-RETURN VALVE NV400

intermediate flange version

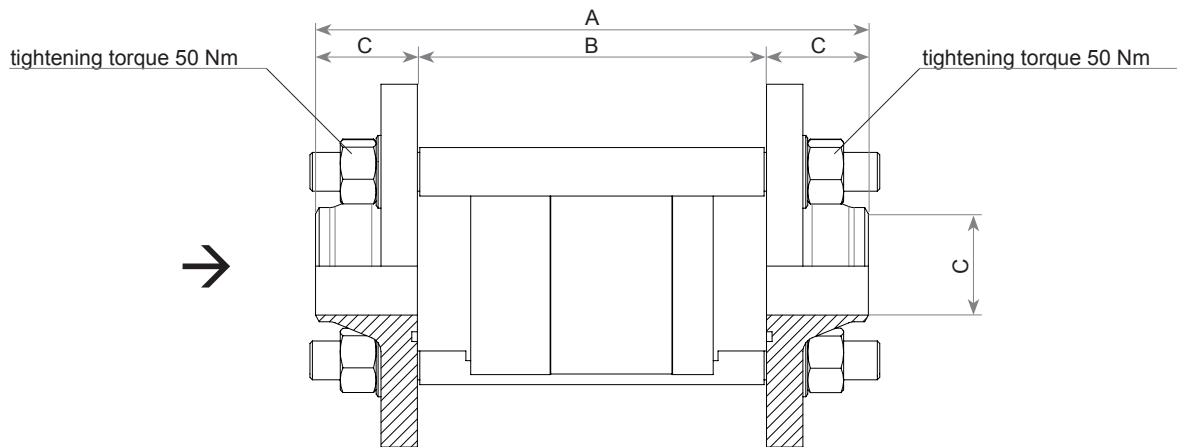

Model	Max. working pressure [bar]	Material	Seal-Material	Dimensions [mm]				Connection [inch]	Order-No.
				A	B	C	D		
NV400 Complete with intermediate flange	16	Housing: Brass or Stainless steel	Elastomer (depending on gas)	228	144	42	43.1	DN40	Brass: 038S-040MS Stainless steel: 038S-040ES
				236	144	46	54.5	DN50	Brass: 038S-050MS Stainless steel: 038S-050ES
NV400	3	Flange: Stainless steel (1.4541) Threaded rods: Stainless steel (1.4301)		-	144	-	-	G 1.1/2 F	Brass: 038-024 Stainless steel 038-014
Intermediate flange set (for retrofitting without NV)	40 bar			-	-	42	43.1	DN40	966034400
				-	-	46	54.5	DN50	966034500

Other connections available upon request

Flow diagram for air (20 °C / 68 °F)

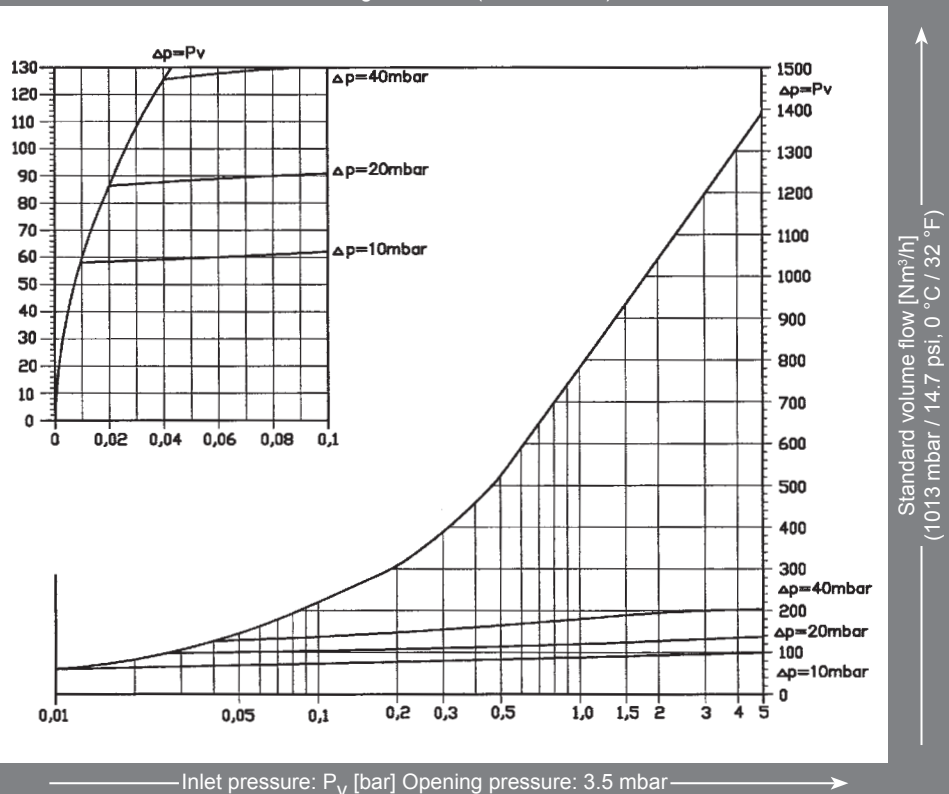

- Conversion factors:
- Butane x 0,68
 - Natural Gas x 1,25
 - Methane x 1,33
 - Propane x 0,80
 - Oxygen x 0,95
 - Town gas x 1,54
 - Hydrogen x 3,75